

ADDENDUM NO. 4

November 9, 2021

CROWN POINT HIGH SCHOOL ADDITIONS AND RENOVATIONS **Crown Point, IN 46307**

TO: ALL BIDDERS OF RECORD

This Addendum forms a part of and modifies the Bidding Requirements, Contract Forms, Contract Conditions, the Specifications, and the Drawings dated October 11, 2021 by Gibraltar Design. Acknowledge receipt of the Addendum in the space provided on the Bid Form. Failure to do so may subject the Bidder to disqualification.

This Addendum consists of Pages ADD 4-1 and attached Addendum No. 4 from Gibraltar Design dated November 8, 2021 and consisting of 2 pages and 6 Drawings.

A. SPECIFICATION SECTION 00 31 00 - BID FORM

1. Replace:

Bid Form with the attached revised Bid Form.

B. SPECIFICATION SECTION 01 12 00 - MULTIPLE CONTRACT SUMMARY

1. BID CATEGORY NO. 1 - GENERAL TRADES

a. Add:

Clarification No. 25:

Reference Note 3 on drawing sheet C-1.2; **The Bid Category No. 1 Contractor** shall include removal of the existing playground equipment to be turned over to the owner.

C. SPECIFICATION SECTION 01 23 00 - ALTERNATES

1. Replace:

Alternate section with the attached revised Alternate section.

CONTRACTOR'S BID FOR PUBLIC WORKS FORM NO. 96

Format (Revised 2013)
(Amended for CPCSC)

**Crown Point High School
Additions and Renovations**
Crown Point Community School Corporation
Crown Point, IN

PART I

(To be completed for all bids. Please type or print)

Date (month, day, year): _____

BIDDER (Firm) _____

Address _____ P.O. Box _____

City/State/Zip _____

Telephone Number: _____ Email Address: _____

Person to contact regarding this Bid _____

Pursuant to notices given, the undersigned offers to furnish labor and/or materials necessary to complete the public works project of:

Insert Category No. (s) and Name(s)

Of public works project, ***Crown Point High School Additions and Renovations***, in accordance with Plans and Specifications prepared by ***Gibraltar Design, 9102 N. Meridian St., Suite 300, Indianapolis, IN 46260***, as follows:

BASE BID

For the sum of _____
(Sum in words)

_____ DOLLARS (\$_____)
(Sum in figures)

The undersigned acknowledges receipt of the following Addenda:

Receipt of Addenda No. (s) _____

PROPOSAL TIME

Bidder agrees that this Bid shall remain in force for a period of sixty (60) consecutive calendar days from the due date, and Bids may be accepted or rejected during this period. Bids not accepted within said sixty (60) consecutive calendar days shall be deemed rejected.

Attended pre-bid conference YES _____ NO _____

Has visited the jobsite YES _____ NO _____

The Bidder has reviewed the Guideline Schedule in Section 01 32 00 and the intent Of the schedule can be met.

YES _____ NO _____

Bidder has included their Written Drug Testing Plan that covers all employees of the bidder who will perform work on the public work project and meets or exceeds the requirements set in IC 4-13-18-5 or IC 4-13-18-6.

YES _____ NO _____

The Skillman Corporation's diversity initiative is to create a program to encourage, assist and measure the active participation of Minority- Owned, Women-Owned, Veteran – Owned and Disabled Individual-Owned Businesses. The Program is to ensure that MWVDBEs are provided full and equal opportunity to participate in all Skillman Corporation's Projects.

Bidder has included:	DBE: YES _____ %	NO _____
	MBE: YES _____ %	NO _____
	WBE: YES _____ %	NO _____
	VBE: YES _____ %	NO _____

The undersigned further agrees to furnish a bond or certified check with this Bid for an amount specified in the Notice to Bidders. If Alternate Bids apply, submit a proposal for each in accordance with the Plans and Specifications.

If additional units of material included in the contract are needed, the cost of units must be the same as that shown in the original contract if accepted by the governmental unit. If the bid is to be awarded on a unit bases, the itemization of the units shall be shown on a separate attachment.

The contractor and his subcontractors, if any, shall not discriminate against or intimidate any employee, or applicant for employment, to be employed in the performance of this contract, with respect to any matter directly or indirectly related to employment because of race, religion, color, sex, national origin, or ancestry. Breach of this covenant may be regarded as a material breach of the contract.

CERTIFICATION OF USE OF UNITED STATES STEEL PRODUCTS

I, the undersigned bidder, or agent as a contractor on a public works project, understand my statutory obligation to use steel products made in the United States (I.C. 5-16-8-2). I hereby certify that I and all subcontractors employed by me for this project will use U.S. steel on this project if awarded. I understand that violations hereunder may result in forfeiture of contractual payments.

ALTERNATE BIDS

A blank entry or an entry of "No Bid", "N/A", or similar entry on any Alternate will cause the bid to be rejected as non-responsive only if that Alternate is selected. If no change in the bid amount is required, indicate "No Change".

****MARK "ADD" OR "DEDUCT" FOR EACH ALTERNATE****

Alternate Bid No. 1 – Cleaning and Repairs to Existing EIFS

Change the Base Bid the sum of _____
(sum in words)
_____ DOLLARS (\$) _____
(sum in figures) ADD
DEDUCT

Alternate Bid No. 2 – Roof System

Change the Base Bid the sum of _____
(sum in words)
_____ DOLLARS (\$) _____
(sum in figures) ADD
DEDUCT

Alternate Bid No. 3 – Temporary Relocation of JV Softball Field

Change the Base Bid the sum of _____
(sum in words)
_____ DOLLARS (\$) _____
(sum in figures) ADD
DEDUCT

Alternate Bid No. 4 – Increased Height of Overhead Door

Change the Base Bid the sum of _____
(sum in words)
_____ DOLLARS (\$) _____
(sum in figures) ADD
DEDUCT

Alternate Bid No. 5 – Boilers Manufactured by Camus

Change the Base Bid the sum of _____
(sum in words)
_____ DOLLARS (\$_____) ADD
(sum in figures) DEDUCT

Alternate Bid No. 6 – Chillers Manufactured by Trane

Change the Base Bid the sum of _____
(sum in words)
_____ DOLLARS (\$_____) ADD
(sum in figures) DEDUCT

Alternate Bid No. 7 – Air Handling Units Manufactured by Trane

Change the Base Bid the sum of _____
(sum in words)
_____ DOLLARS (\$_____) ADD
(sum in figures) DEDUCT

Alternate Bid No. 8 – Chemical Water Treatment by Global Water Technology

Change the Base Bid the sum of _____
(sum in words)
_____ DOLLARS (\$_____) ADD
(sum in figures) DEDUCT

Alternate Bid No. 9 – Fieldturf as the Artificial Turf Manufacturer

Change the Base Bid the sum of _____
(sum in words)
_____ DOLLARS (\$_____) ADD
(sum in figures) DEDUCT

Alternate Bid No. 10 – Mondo as the Rubber Sports Floor Manufacturer

Change the Base Bid the sum of _____
(sum in words)
_____ DOLLARS (\$_____) ADD
(sum in figures) DEDUCT

Alternate Bid No. 11 – New Pole Bases, Poles, Lighting Fixture Heads, Final Electrical Connections

Change the Base Bid the sum of _____
(sum in words)
_____ DOLLARS (\$_____) ADD
(sum in figures) DEDUCT

Alternate Bid No. 12 – Scoreboards Manufactured by Daktronics

Change the Base Bid the sum of _____
(sum in words)
_____ DOLLARS (\$_____) ADD
(sum in figures) DEDUCT

PART II

(For projects of \$150,000 or more – IC 36-1-12-4)

These statements to be submitted under oath by each bidder with and as a part of his bid. (Attach additional pages for each section as needed.)

SECTION I EXPERIENCE QUESTIONNAIRE

1. What public works projects has your organization completed for the period of one (1) year prior to the date of the current bid?

Contract Amount	Class of Work	Completion Date	Name and Address of Owner

2. What public works projects are now in process of construction by your organization?

Contract Amount	Class of Work	Completion Date	Name and Address of Owner

3. Have you ever failed to complete any work awarded to you?_____If so, where and why?

4. List references from private firms for which you have performed work.

SECTION II PLAN AND EQUIPMENT QUESTIONNAIRE

1. Explain your plan or layout for performing proposed Work. (Examples could include a narrative of when you could begin, complete the project, number of workers, etc. and any other information which you believe would enable the governmental unit to consider your bid.)

2. Please list the names and addresses of all subcontractors (i.e. persons or firms outside your own firm who have performed part of the work) that you have used on public works projects during the past five (5) years along with a brief description of the work done by each subcontractor.

3. If you intend to sublet any portion of the work, state the name and addresses of each subcontractor, equipment to be used by the subcontractor, and whether you will required a bond. However, if you are unable to currently provide a listing, please understand a listing must be provided prior to contract approval. Until the completion of the proposed project, you are under a continuing obligation to immediately notify the governmental unit in the event that you subsequently determine that you will use a subcontractor on the proposed project.

4. What equipment do you have available to use for the proposed Project? Any equipment used by subcontractors may also be required to be listed by the governmental unit.

5. Have you into contracts or received offers for all materials which substantiate the prices used in preparing your proposal? If not, please explain the rationale used which corroborate the process listed.

SECTION III CONTRACTOR'S FINANCIAL STATEMENT

Attachment of Bidder's financial statement is mandatory. Any Bid submitted without said financial statement as required by statute shall thereby be rendered invalid. The financial statement provided hereunder to the governing body awarding the Contract must be specific enough in detail so that said governing body can make a proper determination of the Bidder's capability for completing the Project if awarded.

SECTION IV CONTRACTOR NON-COLLUSION AFFIDAVIT

The undersigned Bidder or agent, being duly sworn on oath, says that he has not, nor has any other member, representative, or agent of the firm, company, corporation or partnership represented by him, entered into any combination, collusion or agreement with any person relative to the price to be bid by anyone at such letting nor to prevent any person from bidding nor to induce anyone to refrain from bidding, and that this Bid is made without reference to any other bid and without any agreement, understanding or combination with any other person in reference to such bidding.

He further says that no person or persons, firms, or corporations has, have, or will receive directly or indirectly, any rebate, fee, gift, commission, or thing of value on account of such contract.

SECTION V OATH AND AFFIRMATION

I HEREBY AFFIRM UNDER THE PENALTIES OF PERJURY THAT THE FACTS AND INFORMATION CONTAINED IN THE FOREGOING BID FOR PUBLIC WORKS ARE TRUE AND CORRECT

Dated at _____ this _____ day of _____, 20

(Name of Organization)

By

(Title of Person Signing)

ACKNOWLEDGEMENT

STATE OF _____)
) SS:
COUNTY OF _____)

Before me, a Notary Public, personally appeared the above-named

Swore that the statements contained in the foregoing document are true and correct.

Subscribed and sworn to before me this _____ day of _____,

(Title)

Notary Public

My Commission Expires: _____

County of Residence: _____

END OF SECTION 00 31 00

SECTION 01 23 00 - ALTERNATES

PART 1 - GENERAL

1.01 RELATED DOCUMENTS

- A. Drawings and general provisions of the Contract, including amended General Conditions and other Division 1 Specification Sections, apply to work of this Section.

1.02 PURPOSE

- A. The Bids for the Alternates described herein are required in order for the Owner to obtain information necessary for the proper consideration of the Project in its entirety.

1.03 ALTERNATES

- A. Definitions: Alternates are defined as alternate products, materials, equipment, installations, or systems for the Work, which may, at Owner's option and under terms established by Instructions to Bidders, be selected and recorded in the Owner-Contractor Agreement to either supplement or displace corresponding basic requirements of Contract Documents. Alternates may or may not substantially change scope and general character of the Work; and must not be confused with "allowances", "unit prices", "change orders", "substitutions", and other similar provisions.

1.04 SCHEDULE OF ALTERNATES

- A. ALTERNATE NO. 1: State the cost to provide cleaning and repairs to the existing EIFS as shown on Sheets A-311 thru A-314. **Base Bid:** Cleaning of Brick Veneer.
- B. ALTERNATE NO. 2: State the cost to provide removal of the stone ballast, removal of the existing roof membrane and cover board, and installation of new cover board and fully adhered white EPDM roof system where indicated on Roof Plans. **Base Bid:** Designated areas of roof are to remain ballasted.
- C. ALTERNATE NO. 3: State the cost to provide a temporary relocation for JV Softball, modifying layout and grass areas to provide an IHSA JV Softball layout, bases, and fencing. Fencing is not to be anchored in concrete. **Base Bid:** Leave existing Baseball field as currently installed.
- D. ALTERNATE NO. 4: State the cost to provide an increased height at overhead door between the Stage and Black Box. **Base Bid:** Leave overhead door as is.

- E. ALTERNATE NO. 5: State the cost to provide Boilers manufactured by Camus as indicated on the Mechanical Drawings and Specifications if not already included in your Base Bid.
- F. ALTERNATE NO. 6: State the cost to provide Chillers manufactured by Trane as indicated on the Mechanical Drawings and Specifications if not already included in your Base Bid.
- G. ALTERNATE NO. 7: State the cost to provide Air Handling Units manufactured by Trane as indicated on the Mechanical Drawings and Specifications if not already included in your Base Bid.
- H. ALTERNATE NO. 8: State the cost to provide Chemical Water Treatment manufactured by Global Water Technology, Inc. as indicated on the Plumbing Drawings and Specifications if not already included in your Base Bid.
- I. ALTERNATE NO. 9: State the cost to provide Fieldturf as the Artificial Turf manufacturer as indicated in the Specifications if not already included in your Base Bid.
- J. ALTERNATE NO. 10: State the cost to provide Mondo as the Rubber Sports Floor as indicated in the Specifications if not already included in your Base Bid.
- K. ALTERNATE NO. 11: State the cost to provide new pole bases, poles, and lighting fixture heads, and final electrical connections, as shown on sheet E-003 and scheduled on sheet E-503. **Base Bid:** Site lighting circuitry, wiring, and conduit from existing panelboard and controls to proposed new parking lot site lighting locations for fixture pole bases, poles, and lighting fixture heads.
- L. ALTERNATE NO. 12: State the cost to provide scoreboards manufactured by Daktronics as indicated in the Specifications, if not already included in your Base Bid.

PART 2 - PRODUCTS, PART 3 - EXECUTION (Not Used)

END OF SECTION 01 23 00

ADDENDUM FOUR

Addendum Three (AD.04) to the drawings and specifications prepared by Gibraltar Design and The Skillman Corporation for **Crown Point High School Additions and Renovations** for Crown Point Community School Corporation, Crown Point, Indiana.

All Contractors bidding on this project shall read all of the items covered below and shall comply with all of the requirements as set forth, including any necessary refinements or additions generated by this Addendum, and required by the intent of the original contract documents. All Contractors shall acknowledge on their bid form that they have received this Addendum, Addendum One, Addendum Two, and Addendum Three, and include the appropriate content of same within their bid proposal.

ADDENDUM REVISIONS

1. **Addendum #2, Line Item #7** **For Specification Section 10 11 00**
 - A. Text should read "Delete Paragraph 2.1.A. in its entirety".
2. **Addendum #3, Line Item #10** **For Specification Section 11 66 43**
 - A. Clarifications to Scoreboards, Displays, and Marque locations: Contractors are to assume that the electrical and data connections are matching up to the existing electrical and data connections since all of the units are replacing in-place scoreboards, displays, and Marquee. However, the Contractors are required to provide for miscellaneous structural connections to the locations that might be to replace the existing bolts, anchors, etc.
3. **Addendum #3, Line Item #11** **For Specification Section 13 01 00**
 - A. Clarification to Paragraph B. – Contractor is to provide connection of the Turf Underdrain System into the 15" new Storm Drain pipe below the turf on the east side of the playing turf.

SPECIFICATIONS

1. **Specification Section 23 21 13** **HVAC Piping**
 - A. Add new Paragraph 1.02.B. to read:
 1. B. Drain existing hot water heating and chilled water cooling piping systems and properly dispose of existing glycol water mixture. Upon completion of project, hot water heating and chilled water cooling systems shall be filled with 25% propylene glycol mixture.

DRAWINGS

1. **Sheet C-1.2**
 - A. Refer to full size Sheet included with this addendum - Demolition – Additional asphalt removal and fence removal along southern entrance Road.

2. Sheet C-3.0

- A. Refer to full size Sheet included with this addendum - Master Utilities Plan – Structure #13 is re-routed to tie into Structure #26, Structures #15 & #17 have been removed. A new Structure #34 depicting 85' ~ 2' x 4' Box Culvert has been added replacing the deleted structures, Structure #16 ties directly into the new Box Culvert.

3. Sheet C-3.1

- A. Refer to full size Sheet included with this addendum - Grading, Storm Sewers, Sanitary Sewers & Water Main Plan – A larger depiction of C-3.0.

4. Sheet C-4.0

- A. Refer to full size Sheet included with this addendum - Details & Specifications – New note under "SPECIFICATIONS FOR STORM SEWERS" has been added.

5. Sheet C-5.0

- A. Refer to full size Sheet included with this addendum - Master Storm Water Pollution Plan – Construction – Location of the concrete washout has been moved.

6. Sheet C-5.1

- A. Refer to full size Sheet included with this addendum - Storm Water Pollution Plan – Construction – Location of the concrete washout has been moved.

7. Sheet A-102

- A. Revise the dimension indicated for Storage Room B-114 from 28'-0" length to 26'-0" (VIF).

8. Sheet A-117

- A. Add to project scope, in Indoor Turf T-111, additional framing and padding adjacent to column T16/T-M to incorporate the 8" Storm Drain.

9. Sheet P-217

- A. Add Hose Bibb HB-1 to the southeast corner of Storage Room T-108. Install ¾" cold water line to HB-1 from ¾" cold water serving EWC-1 on adjacent wall in Weights T-109.

Pages 1 through 2, inclusive, and Six (6) Full-Size Drawings constitute the total makeup of Addendum Four.



Z:\2021-5031 Crown Point High School\Drawn\2021-5031.dwg 10/21/2021 9:34:27 AM CDT

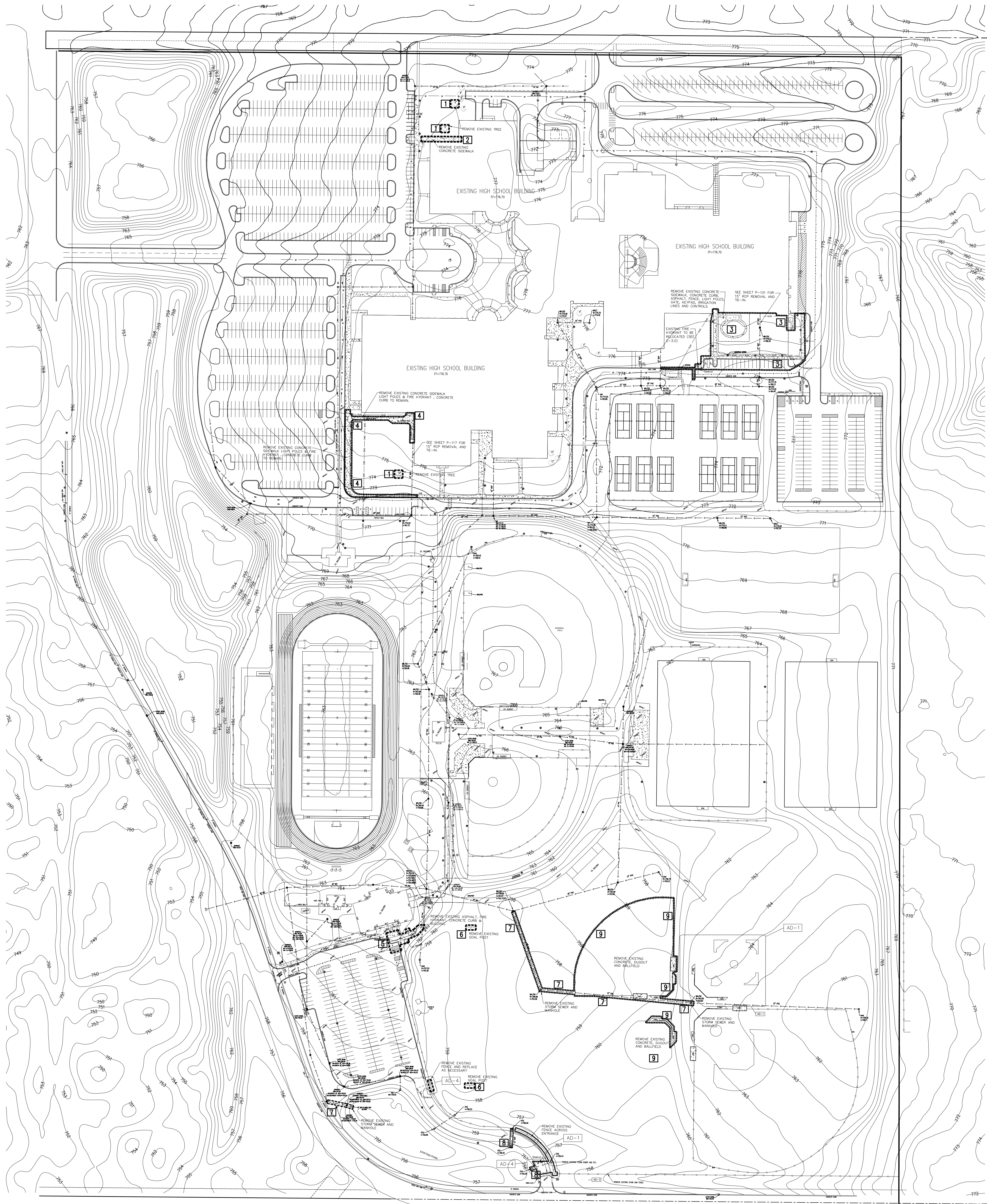

DEMOLITION NOTES

REMOVE WITHIN THE OUTLINED AREA

- 1 REMOVE EXISTING TREE
- 2 REMOVE EXISTING CONCRETE SIDEWALK
- 3 REMOVE EXISTING CONCRETE SIDEWALK, CONCRETE CURB, ASPHALT, FENCE, LIGHT POLES, GATE, KEYPAD, IRRIGATION LINES AND CONTROLS.
- 4 REMOVE EXISTING CONCRETE SIDEWALK LIGHT POLES & FIRE HYDRANT. (CONCRETE CURB TO REMAIN.)
- 5 REMOVE EXISTING ASPHALT, FIRE HYDRANT, CONCRETE CURB & BUILDING.
- 6 REMOVE EXISTING GOAL POST
- 7 REMOVE EXISTING STORM SEWER AND MANHOLE
- 8 REMOVE EXISTING STORM SEWER AND FES
- 9 REMOVE EXISTING CONCRETE, DUGOUT AND BALLFIELD

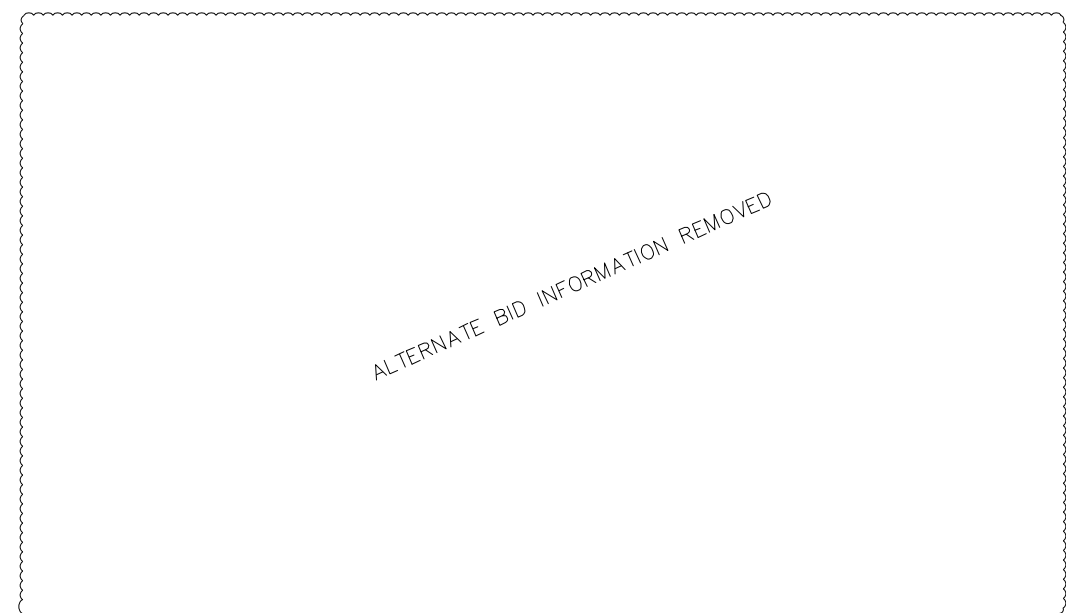

AD-1

NORTH
GRAPHIC SCALE

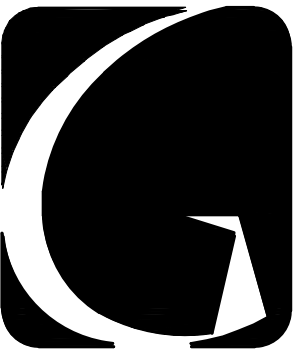
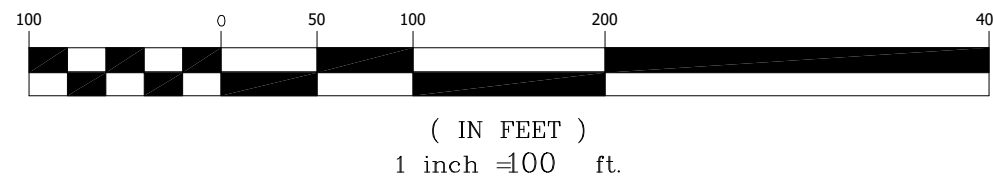

GIBRALTAR
DESIGN
ARCHITECTURE • ENGINEERING • INTERIOR DESIGN

PROJECT CROWN POINT HIGH SCHOOL ADDITIONS AND RENOVATIONS

FOR:
CROWN POINT COMMUNITY
SCHOOL CORPORATION
CROWN POINT, INDIANA

GIBRALTAR DESIGN
9102 N. Meridian St., Ste. 300
Indianapolis, IN 46260
Homepage: www.GibraltarDesign.com
Email: info@GibraltarDesign.com
Phone: 317.580.5777 Fax: 317.580.5778

PROJECT: 21-111
DATE: 10/11/21
COORDINATED BY: DCT
DRAWN BY: DCT/MH/EM
CHECKED BY: DCT

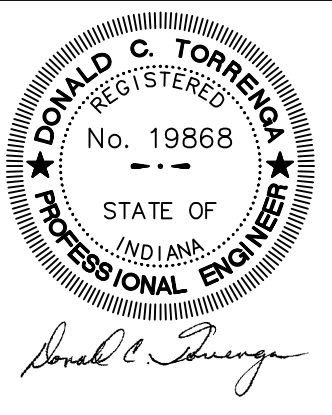

COPYRIGHT NOTICE:
THE CONCEPTS, DESIGNS, PLANS, DETAILS, ETC., SHOWN ON THIS DOCUMENT ARE THE PROPERTY OF GIBRALTAR DESIGN AND WERE CREATED FOR USE ON THIS SPECIFIC PROJECT. NONE OF THIS INFORMATION SHALL BE USED BY ANY PERSON OR FIRM FOR ANY PURPOSE WITHOUT THE EXPRESS WRITTEN CONSENT OF GIBRALTAR DESIGN. THE OWNER MAY RETAIN COPIES FOR INFORMATION AND REFERENCE IN CONNECTION ONLY WITH THIS PROJECT.

REVISIONS		
MARK	DATE	ISSUED FOR
AD-1	10-22-21	ADDENDUM NO. 1
AD-4	11-08-21	ADDENDUM NO. 4

DRAWING
DEMOLITION PLAN

PROJECT
CROWN POINT HIGH SCHOOL
ADDITIONS AND RENOVATIONS

© GIBRALTAR DESIGN SHEET
C-1.2

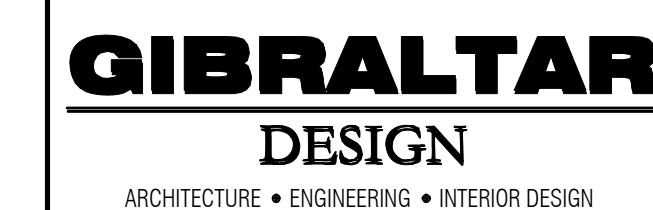

PROJECT
CROWN POINT
HIGH SCHOOL
ADDITIONS AND
RENOVATIONS

FOR:
CROWN POINT COMMUNITY
SCHOOL CORPORATION

CROWN POINT, INDIANA

GIBALTAR DESIGN
9102 N. Meridian St., Ste. 300
Indianapolis, IN 46260
Homepage www.GibraltarDesign.com
Email info@GibraltarDesign.com
Phone 317.580.5777 Fax 317.580.5778

PROJECT 21-111	
DATE 10/11/21	
COORDINATED BY DCT	
DRAWN BY DCT/EM	
CHECKED BY DCT	

COPYRIGHT NOTICE:
THE CONCEPTS, DESIGNS, PLANS, DETAILS, ETC., SHOWN ON THIS DOCUMENT ARE THE PROPERTY OF GIBRALTAR DESIGN AND WERE CREATED FOR USE ON THIS SPECIFIC PROJECT. NONE OF THIS INFORMATION SHALL BE USED BY ANY PERSON OR FIRM FOR ANY PURPOSE WITHOUT THE EXPRESS WRITTEN CONSENT OF GIBRALTAR DESIGN. THE OWNER MAY RETAIN COPIES FOR INFORMATION AND REFERENCE IN CONNECTION ONLY WITH THIS PROJECT.

REVISIONS		
MARK	DATE	ISSUED FOR
AD-1	10-22-21	ADDENDUM NO. 1
AD-4	11-08-21	ADDENDUM NO. 4

DRAWING
MASTER UTILITIES PLAN

PROJECT
CROWN POINT HIGH SCHOOL
ADDITIONS AND RENOVATIONS

© GIBALTAR DESIGN
SHEET
C-3.0

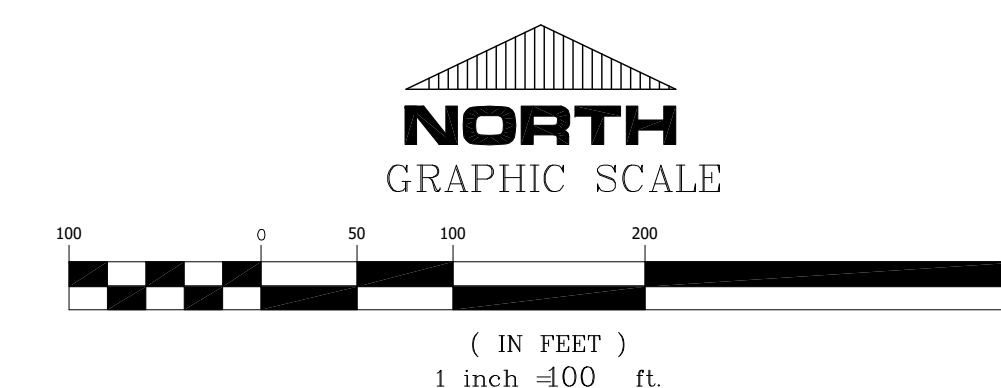

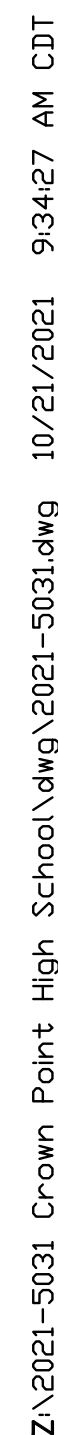

PROJECT

CROWN POINT HIGH SCHOOL ADDITIONS AND RENOVATIONS

FOR:
CROWN POINT COMMUNITY
SCHOOL CORPORATION

CROWN POINT, INDIANA

GIBRALTAR DESIGN

9102 N. Meridian St., Ste. 300
Indianapolis, IN 46260
Homepage www.GibraltarDesign.com
Email info@GibraltarDesign.com
Phone 317.580.5777 Fax 317.580.5778

PROJECT	21-111
DATE	10/11/21

COORDINATED BY:

DCT

DRAWN BY
DCT/EM

CHECKED BY

DCT	
-----	--

COPYRIGHT NOTICE:
THE CONCEPTS, DESIGNS, PLANS, DETAILS, ETC., SHOWN ON THIS DOCUMENT ARE THE PROPERTY OF GIBRALTAR DESIGN AND WERE CREATED FOR USE ON THIS SPECIFIC PROJECT. NONE OF THIS INFORMATION SHALL BE USED BY ANY PERSON OR FIRM FOR ANY PURPOSE WITHOUT THE EXPRESS WRITTEN CONSENT OF GIBRALTAR DESIGN. THE OWNER MAY RETAIN COPIES FOR INFORMATION AND REFERENCE IN CONNECTION ONLY WITH THIS PROJECT.

REVISIONS		
MARK	DATE	ISSUED FOR
AD-1	10-22-21	ADDENDUM NO. 1
AD-4	11-08-21	ADDENDUM NO. 4

DRAWING
GRADING, STORM SEWERS,
SANITARY SEWERS & WATER
MAIN PLAN

PROJECT
CROWN POINT HIGH SCHOOL
ADDITIONS AND RENOVATIONS

© GIBRALTAR DESIGN

C-3.1

Z:\2021-5031 Crown Point High School\dwg\2021-5031 Details.dwg 10/11/2021 8:47:26 AM CDT

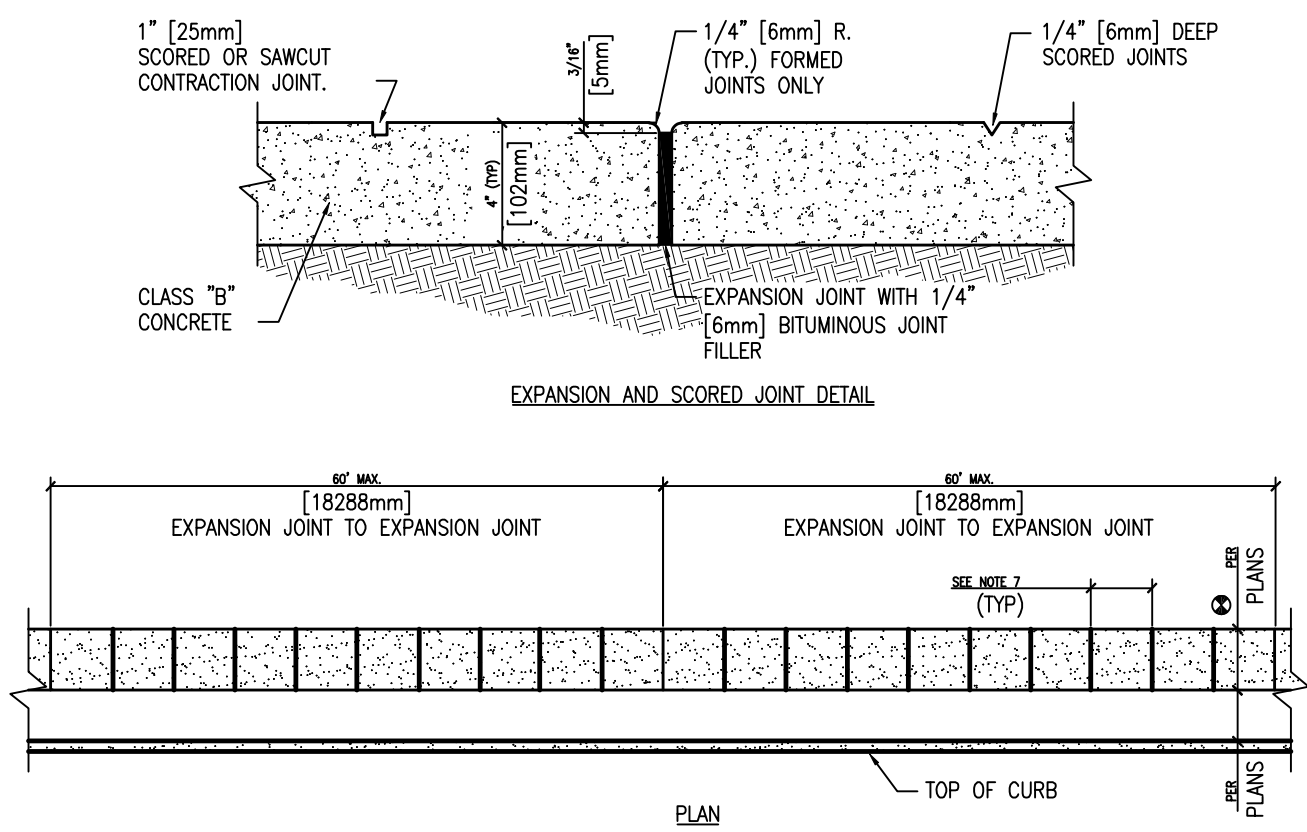

- NOTES:
- EXPANSION JOINTS SHALL BE LOCATED WHERE SIDEWALK ABUTS CONCRETE DRIVEWAYS, CURB OR OTHER ADJACENT STRUCTURES.
 - ONE-HALF INCH BITUMINOUS JOINT FILLER SHALL BE INSTALLED AT EXPANSION JOINT LOCATIONS AND SHALL EXTEND THE FULL DEPTH OF THE CONCRETE.
 - 1" DEEP CONTRACTION JOINTS SHALL BE PLACED AT INTERVALS OF APPROXIMATELY 15' (4572mm) OR AT A SPACING THAT MATCHES THE ADJACENT CURB.
 - FORMED CONTRACTION JOINTS SHALL BE FINISHED WITH A TOOL HAVING A 1/4" (6mm) RADIUS.
 - SCORED JOINTS SHALL BE 1/4" (6mm) DEEP AND PLACED AT THE SPACING INDICATED FOR THE WIDTH OF SIDEWALK OR MATCH SCORED JOINTS OF ADJACENT CURB.
 - CONCRETE SHALL BE FINISHED BY MEANS OF A FLOAT, STEEL TROWELLED AND BROOMED WITH A FINE BRUSH IN A TRANSVERSE DIRECTION.
 - 1/4" DEEP SCORED JOINTS (TYP) SPACED AT 6' (1829mm) OR EQUAL TO SIDEWALK WIDTH.

CONCRETE SIDEWALK
NOT TO SCALE

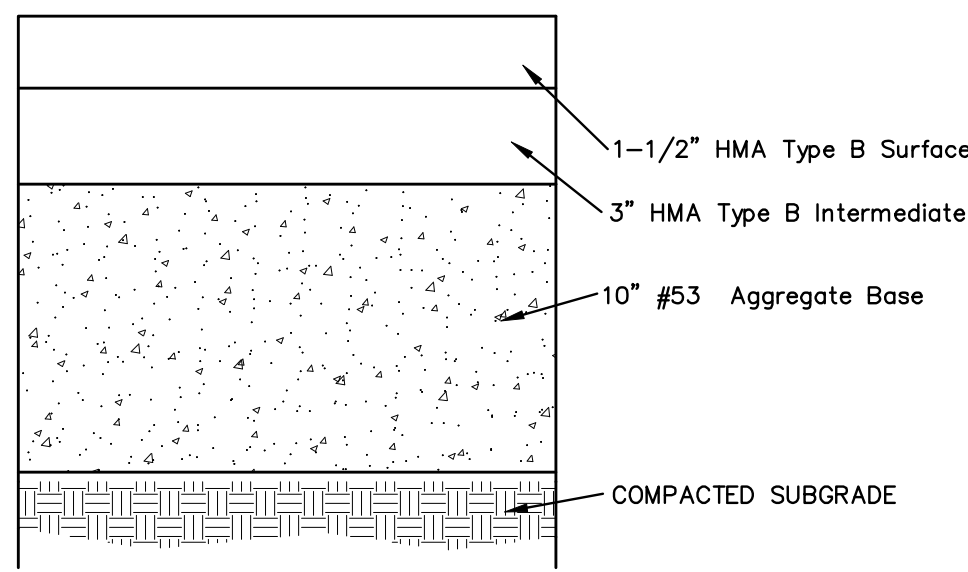

- NOTES:
- WHERE FILL IS REQUIRED, SUBGRADE SHALL BE COMPACTED TO 95% OF THE MAXIMUM DRY DENSITY AS DETERMINED BY ASTM D698 METHOD OF TESTING.
 - THE CONTRACTOR IS RESPONSIBLE FOR CORRECTING ANY PONDING PROBLEMS THAT MAY OCCUR AFTER THE FINAL SURFACE IS LAID.

TYPICAL ASPHALT PAVEMENT SECTION
NOT TO SCALE

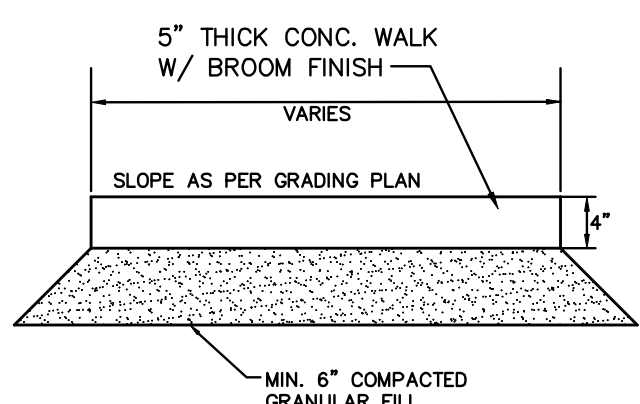

- NOTE:
- ALL JOINTS ARE TO BE SAWCUT. NO SCORED (TOOLED) JOINTS ARE ALLOWED.
 - FOR EXPANSION JOINTS, SEE 20' STIFF AT TOP & DIMENSION WITH 1/4" SEALANT.
 - CURB AND SIDEWALK SHALL RECEIVE SPEEDY CONCRETE CURE. EARTH DRYDOTE MOISTURE STOP MUST BE USED.

TYPE C
SIDEWALK CROSS-SECTION
NOT TO SCALE

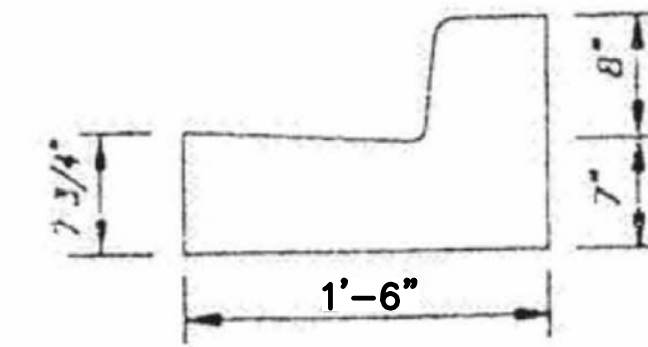

COMBINED CONCRETE HIGH BACK CURB AND GUTTER
NOT TO SCALE

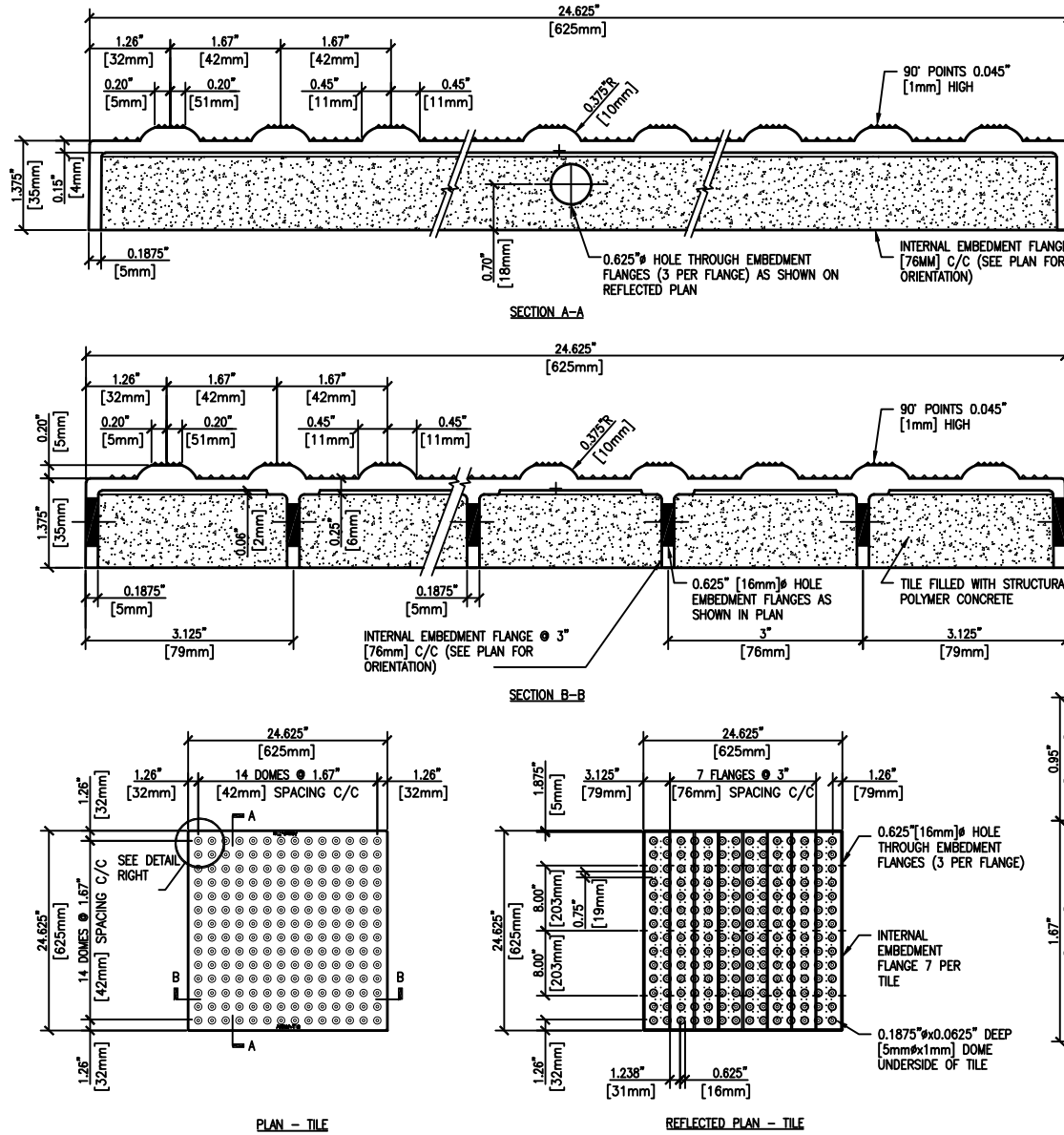

TRUNCATED DOME TACTILE - WARNING STRIP
NOT TO SCALE

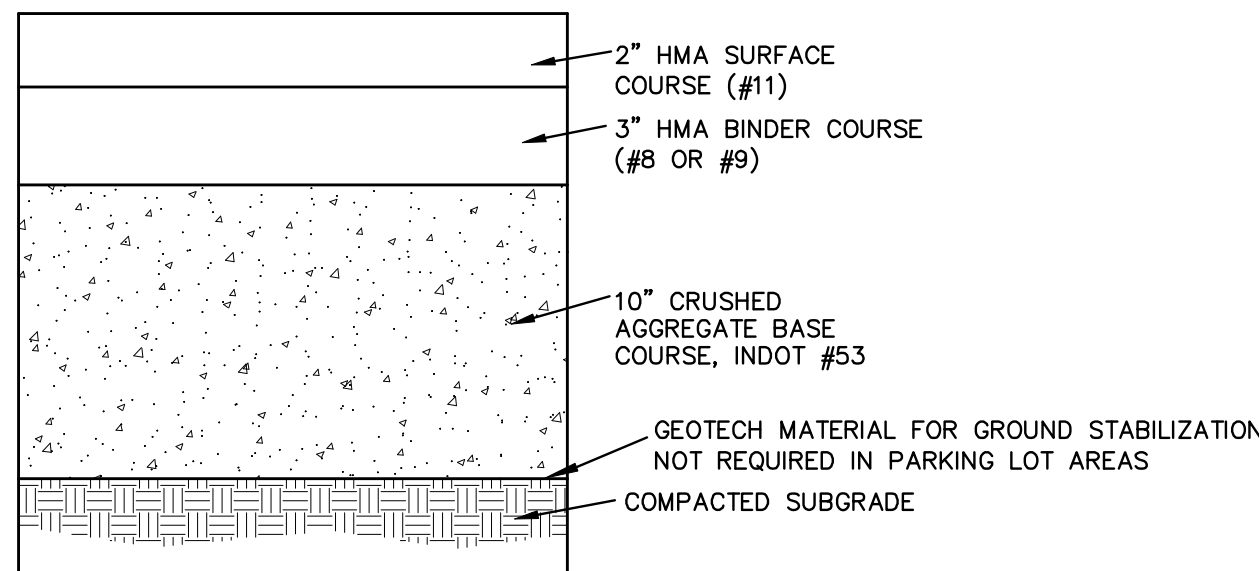

- NOTES:
- WHERE FILL IS REQUIRED, SUBGRADE SHALL BE COMPACTED TO 95% OF THE MAXIMUM DRY DENSITY AS DETERMINED BY ASTM D698 METHOD OF TESTING.
 - THE CONTRACTOR IS RESPONSIBLE FOR CORRECTING ANY PONDING PROBLEMS THAT MAY OCCUR AFTER THE FINAL SURFACE IS LAID.

HEAVY DUTY ASPHALT PAVEMENT SECTION
(NO SCALE)

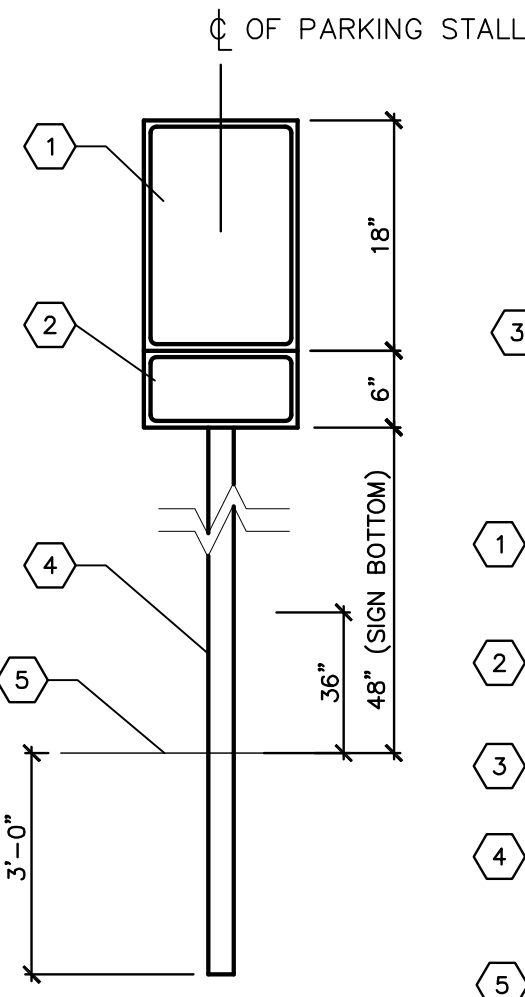

SIGN AND POST (FREE STANDING)
NOT TO SCALE



R3-5R STOP SIGN

KEYED NOTES

- STANDARD USDOT R7 SIGN (BOTH SIDES-WHERE APPLICABLE).
- SUPPLEMENTAL SIGNS, \$-FINE AS APPLICABLE.
- STANDARD USDOT R3-5R STOP SIGN
- 2"x2" GALVANIZED STEEL SQUARE TUBE EXTENDED INTO GROUND, 3'-0"
- FINISH GRADE.

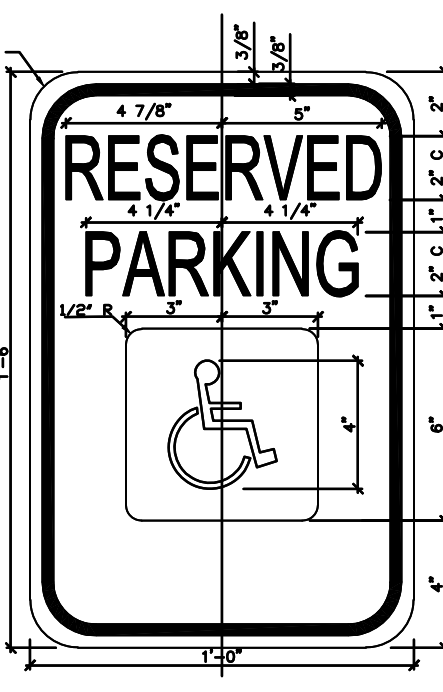

RESERVED PARKING

ACCESSIBILITY SIGNAGE
NOT TO SCALE

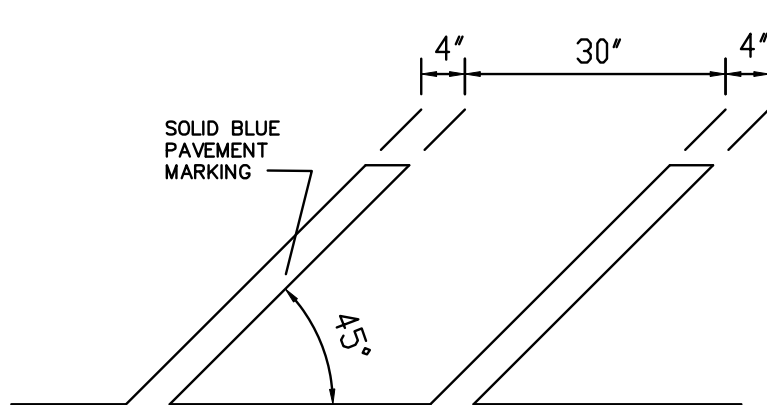

ACCESSIBILITY AND PARKING STRIPING DETAIL
NOT TO SCALE

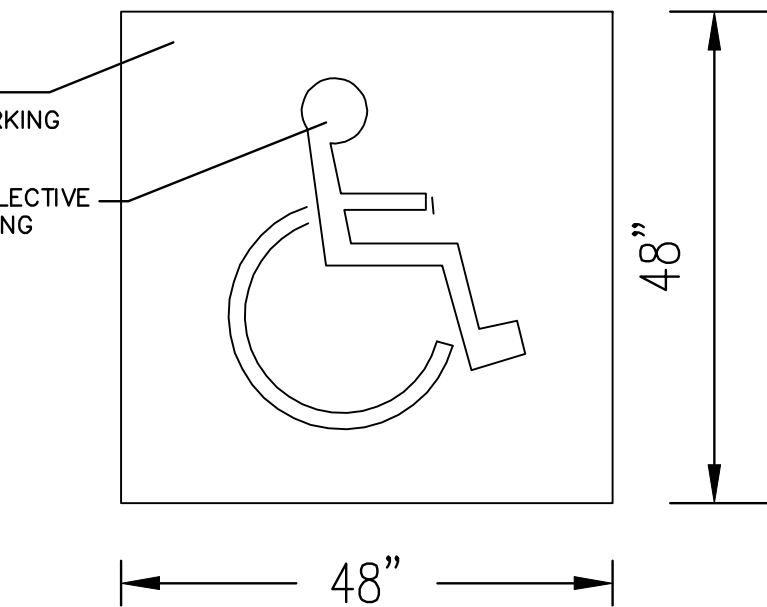

INTERNATIONAL SYMBOL FOR ACCESSIBILITY
NOT TO SCALE



INTERNATIONAL SYMBOL OF ACCESSIBILITY DISPLAY CONDITIONS
NOT TO SCALE

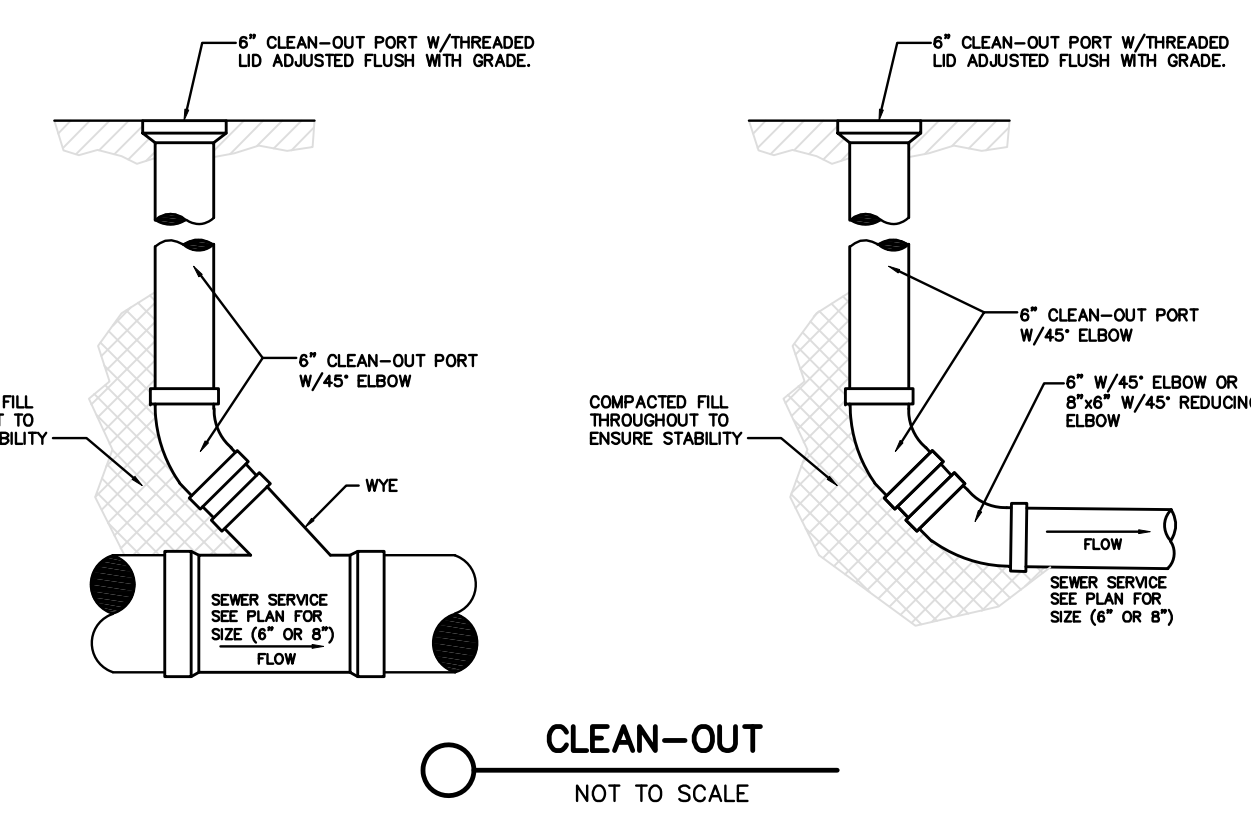

CLEAN-OUT
NOT TO SCALE

Low Profile Native Grass	NWL to Limits of Seeding
Botanical Name	Common Name
Andropogon scoparius	Little Blue Stem
Bouteloua curtipendula	Side Oat Grama
Elymus canadensis	Canada Wild Rye
Sporobolus heterolepis	Phalaris Dropseed
Agrostis alba	Redtop
Perennial Ryegrass	
Alfa Fescue	
Ky. Bluegrass	
Creeping Red fescue	
Slender Wheat Grass	
Cover Crop	
Annual Ryegrass	Annual Rye
Avena sativa	Common Oat

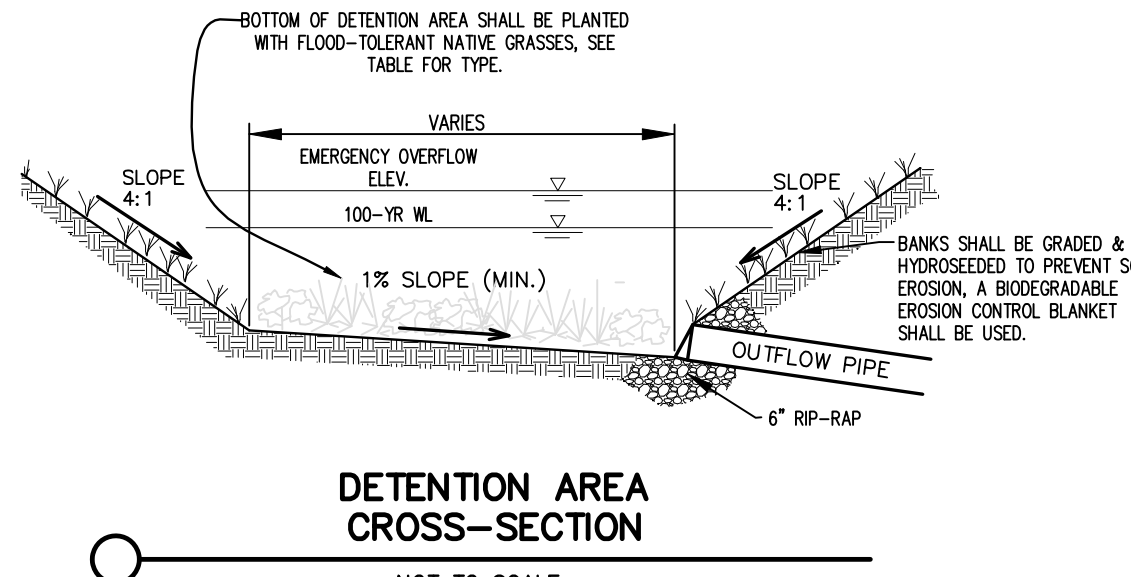

DETENTION AREA CROSS-SECTION
NOT TO SCALE

SPECIFICATIONS FOR SANITARY SEWER AND WATER MAINS

- All sanitary sewer pipe, branches, and fittings shall conform to the following. Poly-vinyl chloride, SDR 26 (ASTM D-3034), with push-on rubber gasket joints (ASTM C-3212).
- All sanitary sewer manholes shall be standard 48" diameter precast concrete units (ASTM C-478) conforming with the standard detail sheets of these plans. Mortar joints are not allowed on manholes, all joints must be rubber gaskets.

- The Developer is responsible for the preparation of "As Built" construction drawings showing actual sizes and lengths of pipe installed (i.e. from manhole to manhole or to valve, etc.), location of service taps and any structures added or omitted in comparison with these engineering plans. The Developer shall supply the City of Crown Point with one reproducible drawing certified by a Professional Engineer or Land Surveyor and 2 copies thereof prior to and as a condition of the final acceptance.

- All water main pipe shall be Ductile Iron Pipe (AWWA C-151, C-52) with bell and spigot push-on rubber gasket joints (AWWA C111). All water main pipe shall be installed with a minimum cover of 5.0 feet from the top of the curb to the top of the pipe. All water mains shall be chlorinated at the time of installation and shall be subject to a test for pressure and purity. The Contractor shall notify the City of Crown Point when the water main system (or portion thereof) is ready for testing. All fire hydrants, tees, bends and fittings shall be suitable harnessed or thrust blocked with concrete.

- All improvements installed across paved or future paved areas, driveways and sidewalks shall backfilled with graded stone aggregate to the subgrade line. Compaction shall be done in 8" maximum depth lifts to 95% maximum density.

- Care should be taken in parkway areas to assure compaction acceptable for the stability of proposed driveways and sidewalks. While special backfill is not required, it shall be the responsibility of the contractor to protect against substantial future settlement of backfilled areas.

- Air pressure test shall be performed on all completed Sanitary Manholes and existing manholes where the proposed sanitary system will connect to, in accordance with ASTM C 1244-93, Standard Test Method for Concrete Sewer Manholes by Negative Air Pressure (Vacuum) Test. The tests shall be conducted prior to backfill to demonstrate the integrity of the installed materials. The manhole shall pass if the test time meets or exceeds the required minimum test times as specified in ASTM C 1244-93 for the vacuum reading to drop from 10 inches of mercury to 9 inches of mercury. If the manhole fails the initial test, necessary repairs shall be made, and the test shall be repeated. The contractor shall be responsible for supplying all testing materials and appurtenances. The City of Crown Point shall be notified when the manholes (or portion thereof) are ready for testing.

- Deflection tests shall be performed on all flexible pipe materials placed. The contractor shall be responsible for supplying testing materials and appurtenances. The tests shall be conducted after the final backfill has been in place at least 30 days. No pipe shall exceed a deflection of 5%. If the deflection test is to be run using a rigid ball or mandrel, it shall have a diameter equal to 95% of the inside diameter of the pipe. The test shall be performed without mechanical pulling devices. The City of Crown Point shall be notified when the system (or portion thereof) is ready for testing.

- All sewers shall be laid at least 10 feet (3.0 m) horizontally from any existing or proposed water main. The distance shall be measured edge to edge. All sewers crossing water mains shall be laid to provide a minimum vertical distance of 18 inches (46 cm) between the outside of the water main and the outside of the sewer. This shall be the case where the water main is either above or below the sewer. The crossing shall be arranged so that the sewer joints will be equidistant and as far as possible from the water main joints. Where a water main crosses under a sewer, adequate structural support shall be provided for the sewer to prevent damage to the water main. When it is impossible to obtain proper horizontal and vertical separation as stipulated above, the sewer shall be designed and constructed equal to water pipe.

- The newly installed force main (or portions thereof) shall be subjected to a pressure and leakage test, using hydrostatic testing. Test pressure shall not be less than 1.25 times the working pressure or exceed pipe design pressure. Pressure shall not vary by more than 45 PSI for a minimum of a 2 hour duration test. The exposed pipe and joints shall be examined carefully during the test, and any damaged or defective pipe or joints shall be replaced, and the test shall be repeated. The allowable leakage shall not exceed 11.65 gpd/m of nominal pipe diameter at a pressure of 150 PSI. All visible leaks are to be repaired regardless of the amount of leakage. The contractor shall be responsible for supplying all testing materials and appurtenances. The City of Crown Point shall be notified when the force main (or portion thereof) is ready for testing. Force Main shall be Polyvinyl Chloride, PVC C-900 conforming to AWWA C-900, Class 200 and all testing shall be in accordance with AWWA Standard C-600-93. The Force Main shall be installed with a minimum cover of 5.0 feet (60") to the top of the pipe.

- All Force Main bends and fittings shall be suitably restrained with reaction blocking, restrained joints or clamps with concrete. Reaction Blocking shall be designed for a minimum internal pipe pressure of 150 psi. U.S. pipe field "A-LOK" Gasket system or approved equal shall prevail for concrete blocking on 4-inch through 12-inch pipe.

- No sanitary sewer manhole shall be within eight (8) feet of a water main as measured from the outside edge of the sanitary sewer manhole to the outside edge of the water main.

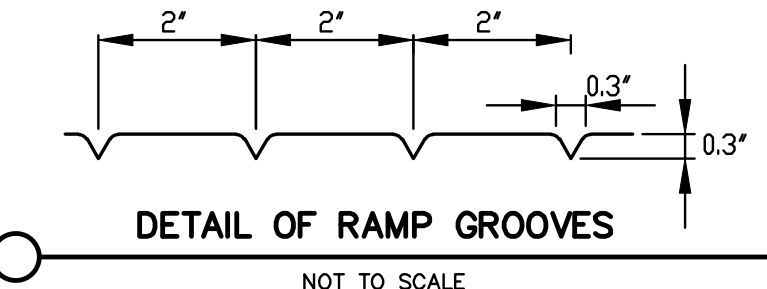

DETAIL OF RAMP GROOVES
NOT TO SCALE

SPECIFICATIONS FOR STORM SEWERS

- All work shall be performed in accordance with the Codes, Ordinances and Standards of the City of Crown Point, Lake County, Indiana.
- All storm sewer pipe, branches and fittings shall conform to either of the following: Poly Vinyl Chloride Pipe (AASHTO M252), Polyethylene Pipe (ASHTO M252 or AASHTO M294), Concrete Pipe (AASHTO M170).
- All storm sewer manholes shall conform to either of the following: (A) Standard precast concrete units (ASTM C-478) and/or (B) Poly-Vinyl Chloride (PVC) Structure. Nylonplast or equal conforming with the standard detail sheet of these plans. Mortar joints are not allowed on manholes, all joints must be rubber gaskets.

- All improvements installed across paved or future paved areas driveways, and sidewalks shall backfilled with graded stone aggregate to the subgrade line. Compaction shall be done in 8" maximum depth lifts to 95% maximum density.

- Care should be taken in parkway areas to assure compaction acceptable for the stability of proposed driveways and sidewalks. While special backfill is not required, it shall be the responsibility of the contractor to protect against substantial future settlement of backfilled areas.

- The Developer is responsible for the preparation of "As Built" construction drawings showing actual sizes and lengths of pipe installed (i.e. from manhole to manhole or to valve, etc.), location of service taps and any structures added or omitted in comparison with these engineering plans. The Developer shall supply the City of Crown Point with one reproducible drawing certified by a Professional Engineer or Land Surveyor and 2 copies thereof prior to and as a condition of the final acceptance.

- All sewers shall be laid at least 10 feet (3.0 m) horizontally from any existing or proposed water main. The distance shall be measured edge to edge. All sewers crossing water mains shall be laid to provide a minimum vertical distance of 18 inches (46 cm) between the outside of the water main and the outside of the sewer. This shall be the case where the water main is either above or below the sewer. The crossing shall be arranged so that the sewer joints will be equidistant and as far as possible from the water main joints. Where a water main crosses under a sewer, adequate structural support shall be provided for the sewer to prevent damage to the water main. When it is impossible to obtain proper horizontal and vertical separation as stipulated above, the sewer shall be designed and constructed equal to water pipe.

- No storm sewer manhole shall be within eight (8) feet of a water main as measured from the outside edge of the sanitary sewer manhole to the outside edge of the water main.

- All storm sewer installed under pavement shall be SDR26 grade.

GENERAL SPECIFICATIONS

- In areas of unsuitable soil, the contractor shall be responsible removal, replacement, and disposal of the soil.

- Replacement and addition of structural soil under roads, pavement and building shall be done in lifts not to exceed 8-inches, with a required compaction of at least 95% of their maximum dry density can be obtained, in accordance with the Indiana Department of Transportation Standard Specifications.

- The contractor shall provide full depth saw cuts where existing pavement, concrete or asphalt is to be removed. The contractor shall provide adequate compacted material/gravel at saw cut edge to shore up and prevent the degradation of existing pavement to remain. Damage to existing pavement will be repaired at the contractor's expense.

- The Occupational Safety and Health Administration recommends that walking surfaces have a static coefficient of friction of 0.5. A research project sponsored by the Architectural and Transportation Barriers Compliance Board (Access Board) conducted tests with persons with disabilities and concluded that a higher coefficient of friction was needed by such persons. A static coefficient of friction of 0.6 is recommended for accessible routes and 0.8 for ramps.



GIBRALTAR
DESIGN
ARCHITECTURE • ENGINEERING • INTERIOR DESIGN

PROJECT

**CROWN POINT
HIGH SCHOOL
ADDITIONS AND
RENOVATIONS**

FOR:
**CROWN POINT COMMUNITY
SCHOOL CORPORATION**

CROWN POINT, INDIANA

GIBRALTAR DESIGN

9102 N. Meridian St., Ste. 300
Indianapolis, IN 46260
Homepage: www.GibraltarDesign.com
Email: info@GibraltarDesign.com
Phone: 317.580.5777 Fax: 317.580.5778

PROJECT

21-111

DATE

10/11/21

COORDINATED BY

DCT

DRAWN BY

NM/SP/EM

CHECKED BY

DCT

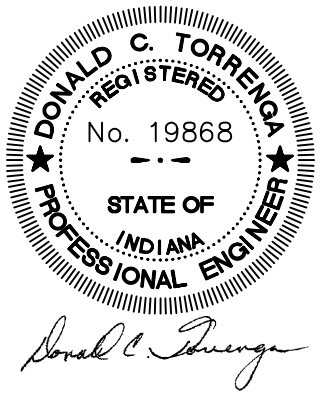

COPYRIGHT NOTICE:

THE CONCEPTS, DESIGNS, PLANS, DETAILS, ETC., SHOWN ON THIS DOCUMENT ARE THE PROPERTY OF GIBRALTAR DESIGN AND WERE CREATED FOR USE ON THIS SPECIFIC PROJECT. NONE OF THIS INFORMATION SHALL BE USED BY ANY PERSON OR FIRM FOR ANY PURPOSE WITHOUT THE EXPRESS WRITTEN CONSENT OF GIBRALTAR DESIGN. THE OWNER MAY RETAIN COPIES FOR INFORMATION AND REFERENCE IN CONNECTION ONLY WITH THIS PROJECT.

REVISIONS

MARK	DATE	ISSUED FOR
AD-1	10-22-21	ADDENDUM NO. 1
AD-4	11-08-21	ADDENDUM NO. 4

DRAWING

DETAILS & SPECIFICATIONS

PROJECT

**CROWN POINT HIGH SCHOOL
ADDITIONS AND RENOVATIONS**

© GIBRALTAR DESIGN

SHEET

C-4.0

Z:\2021-5031 Crown Point High School\dwg\2021-5031.dwg 8/5/2021 11:09:04 AM DDT

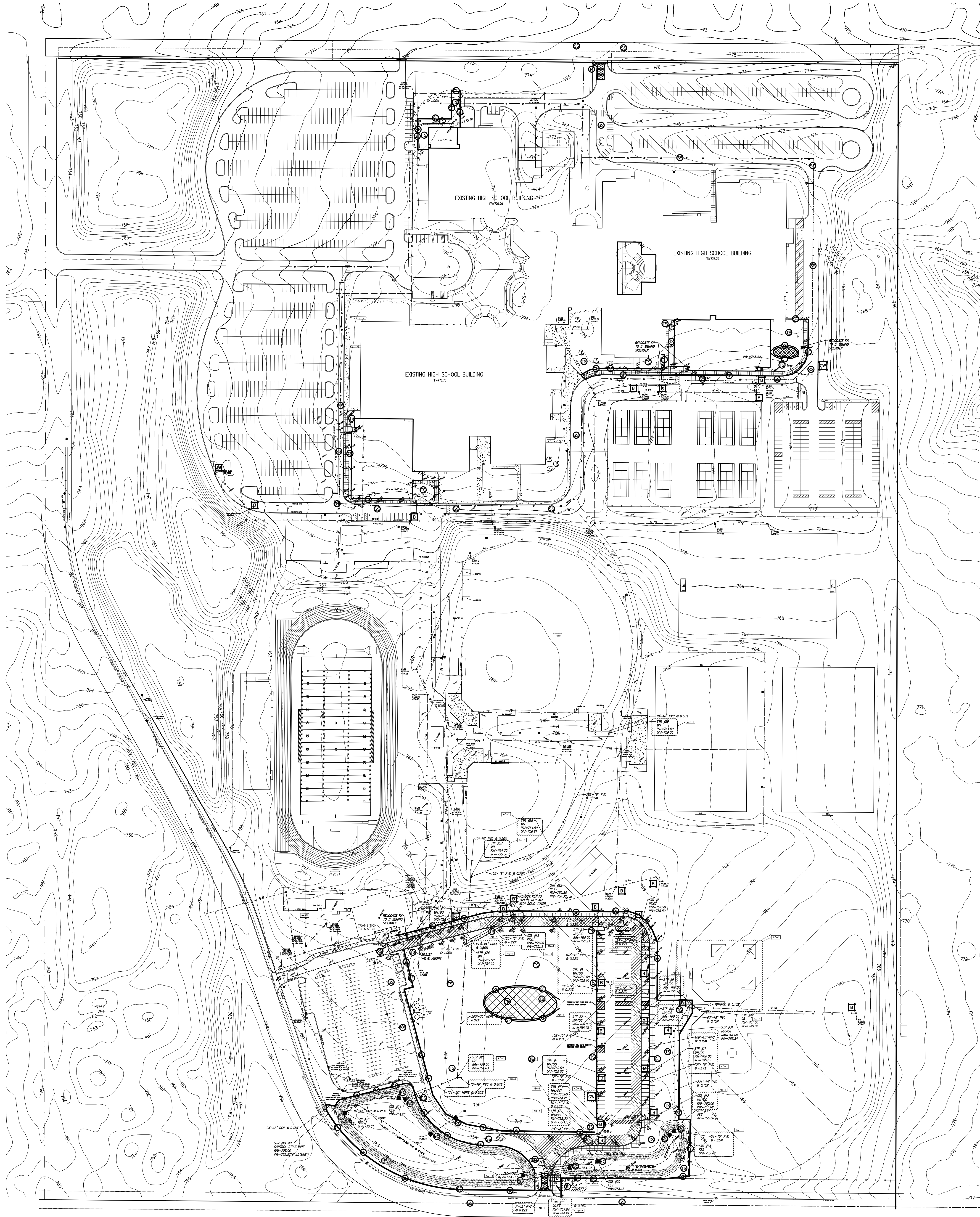

GENERAL NOTES:

- THIS PROPERTY IS LOCATED IN FLOOD ZONE X (AREAS DETERMINED TO BE OUTSIDE 0.2% ANNUAL CHANCE FLOODPLAIN). THERE ARE NO FLOODWAYS AND FLOODWAY FRINGES ON THIS PROPERTY. AS TAKEN FROM FEMA FLOOD INSURANCE RATE MAPS (FIRM) FOR THE CITY OF CROWN POINT, LAKE COUNTY, INDIANA, MAP NUMBER 18089C0263E.
- 04040001030040 MAIN BEAVER DAM DITCH - NILES DITCH
07120001130060 LAKE DALECARLIA - CEDAR LAKE
- STATE OR FEDERAL WATER QUALITY PERMITS ARE REQUIRED FOR THE PROJECT. A NATIONAL POLLUTANT DISCHARGE ELIMINATION SYSTEM (NPDES) IDEM RULE 5 WATER QUALITY PERMIT IS REQUIRED.
- AT PRESENT THE SITE IS AN EXISTING SCHOOL WITH SURROUNDING PARKING AREAS, PONDS AND SPORTS FIELDS.
- THERE IS PRESENCE OF HYDRIC SOILS ON THIS PROPERTY, (PC) PEWAMO SILTY CLAY LOAM.
- THERE ARE NO EXISTING WETLAND AREAS ON THIS PROPERTY BUT DO EXIST ON ADJACENT PROPERTY AS CLASSIFIED BY THE U.S. FISH AND WILDLIFE SERVICE, NATIONAL WETLANDS INVENTORY, AND THE UNITED STATES DEPARTMENT OF THE INTERIOR. THERE ARE NO LAKES OR WATER COURSES BUT A DETENTION POND DOES EXIST ON THIS PROPERTY. MAIN BEAVER DAM DITCH - NILES DITCH IS THE WATER COURSE WHICH THE STORMWATER FROM THE NORTHEAST AREA OF THE PROPOSED SITE WILL ULTIMATELY DISCHARGE INTO. AND LAKE DALECARLIA - CEDAR LAKE IS THE WATER COURSE WHICH THE STORMWATER FROM THE WEST OF THE PROPOSED SITE WILL ULTIMATELY DISCHARGE INTO. A TRIBUTARY IS LOCATED ON THE PROJECT SITE.
- POTENTIAL SOURCE OF STORM WATER DISCHARGE ENTERING THE GROUNDWATER FROM THIS DEVELOPMENT WILL BE THROUGH NATURAL GROUND ABSORPTION ONLY. THERE ARE NO ABANDONED WELLS OR SINKHOLES ON THE PROPERTY.
- THERE ARE NO SENSITIVE AREAS ASSOCIATED WITH THIS PROPERTY.
- THERE ARE NO REGULATED DRAINS WITHIN THIS PROPERTY, OR ON ADJACENT PROPERTIES. THERE IS RECORD OR KNOWLEDGE OF EXISTING FARM DRAINS OR FIELD TILE, INLETS AND OUTFALLS LOCATED WITHIN THE EXISTING PROPERTY LIMITS.
- SOIL STOCKPILES, BORROW AND DISPOSAL AREAS ARE LOCATED WITHIN THE PROJECT SITE. SOIL STOCKPILES SHALL BE SURROUNDED WITH SILT FENCING AT ALL TIMES TO PREVENT EXCESSIVE EROSION, AND IF LEFT UNDISTURBED FOR A PERIOD OF MORE THAN 14 DAYS, IT SHALL BE TEMPORARILY SEED. UPON SITE COMPLETION, THE TOPSOIL STOCKPILE SHALL BE RESPAID, GRADED, AND PERMANENTLY SEED. SOIL STOCKPILES SHALL NOT BE LEFT ON THE SITE FOR GREATER THAN 6 MONTHS AFTER CONSTRUCTION IS COMPLETED. NO SOIL FROM THE STOCKPILES SHALL BE REMOVED FROM THE SITE. ALL EXTRA STOCKPILE MATERIAL SHALL BE RESPAID IN AREAS DESIGNATED BY THE CONSTRUCTION MANAGER.
- AREAS WHERE THE PROPOSED DETENTION AREA, BUILDING, AND DRIVES AS WELL AS AREAS WHERE PROPOSED UTILITIES ARE LOCATED WILL BE DISTURBED DURING CONSTRUCTION. IN ALL OTHER AREAS, EXISTING VEGETATIVE COVER WILL BE PRESERVED.
- FUEL STORAGE AREA IF REQUIRED SHALL BE WITHIN THE CONSTRUCTION STAGING AREA. FUEL SHALL BE STORED IN APPROVED MOBILE REFUELING TANK LOCATED AWAY FROM DRAINAGE STRUCTURES AND CHANNELS. FIRE EXTINGUISHERS SHALL BE LOCATED NEAR FUEL STORAGE AREA AND BE OF SUITABLE TYPE, POSTED, AND BE MAINTAINED IN GOOD CONDITION.
- TEMPORARY SEED ALL AREAS OF BARE SOIL (WITH THE ADDITION OF A BLANKET WHERE SLOPES ARE 4:1 OR GREATER) THAT WILL REMAIN UNDISTURBED FOR A PERIOD OF MORE THAN 14 DAYS. SEEDING: OPTIMUM SEEDING DATES ARE MARCH 1 - MAY 10 AND AUGUST 10 - SEPTEMBER 30. SEEDING DATES BETWEEN MAY 10 AND AUGUST 10, MAY NEED TO BE IRRIGATED. FOR SEEDING RECOMMENDATIONS SEE PRACTICE 3.12, INDIANA STORM WATER QUALITY MANUAL.
- LOCATION OF CITY'S STORMWATER PERMIT AND THE ON-SITE POSTING, OF THE COMPLETE RULE 5 NOI WITH ASSIGNED PERMIT NUMBER, NOS LETTERS AND LOCATION OF THE COMPLETE SET OF ENGINEERING PLANS, SHALL BE AVAILABLE AT THE ENTRANCE TO THE SITE AND VISIBLE TO THE PUBLIC.
- ALL APPLICABLE MATERIAL SAFETY DATA SHEETS (MSDS) SHOULD BE INCLUDED ON-SITE FOR MATERIALS EXPECTED POLLUTANTS OF CONCERN FOR THE PROJECT SITE.
- SITE ELEVATIONS ARE BASED ON NAVD 88, AND HORIZONTAL DATUM IS BASED ON INDIANA STATE PLANE COORDINATES NAD 83.

Temporary stabilization plans and sequence of implementation.

- On site posting of the complete Rule 5 NOI, NOS letter, and City Stormwater Permit. Location of the posting and plans shall be made available by the owners contractor.
- Installation of all erosion/sedimentation controls including stabilized construction entrance, silt fences, etc., per the engineering plans.
- Clearing and grubbing.
- Topsoil stockpile surrounded with silt fencing.
- Rough cut and fill of all proposed detention area, and other major grading per the engineering plans shall be done to rough grades at the start of construction to prevent excessive soil erosion due to construction.
- Silt fence to be placed around the perimeter of the detention basin once it has been completed and stabilized.
- Construction of storm sewers and other utility.
- Implementation of storm sewer inlet protection at each open-grate structure (basket insert inlet protection, as per engineering plans).
- Construct buildings and driveway.
- Upon site completion when no additional disturbance is anticipated stockpile shall be respired, graded, and all disturbed areas shall be permanent seeded, mulched, and landscaped.
- Complete permanent erosion control and restoration of site vegetation. Erosion control measures are to be removed upon permanent vegetative cover being established. Note the NOI letter will remain active until NOTI letter is filed, weekly inspections and inspections after a 0.5-inch rainfall event shall be required by owner.
- Submit NOTI letter for Rule 5.

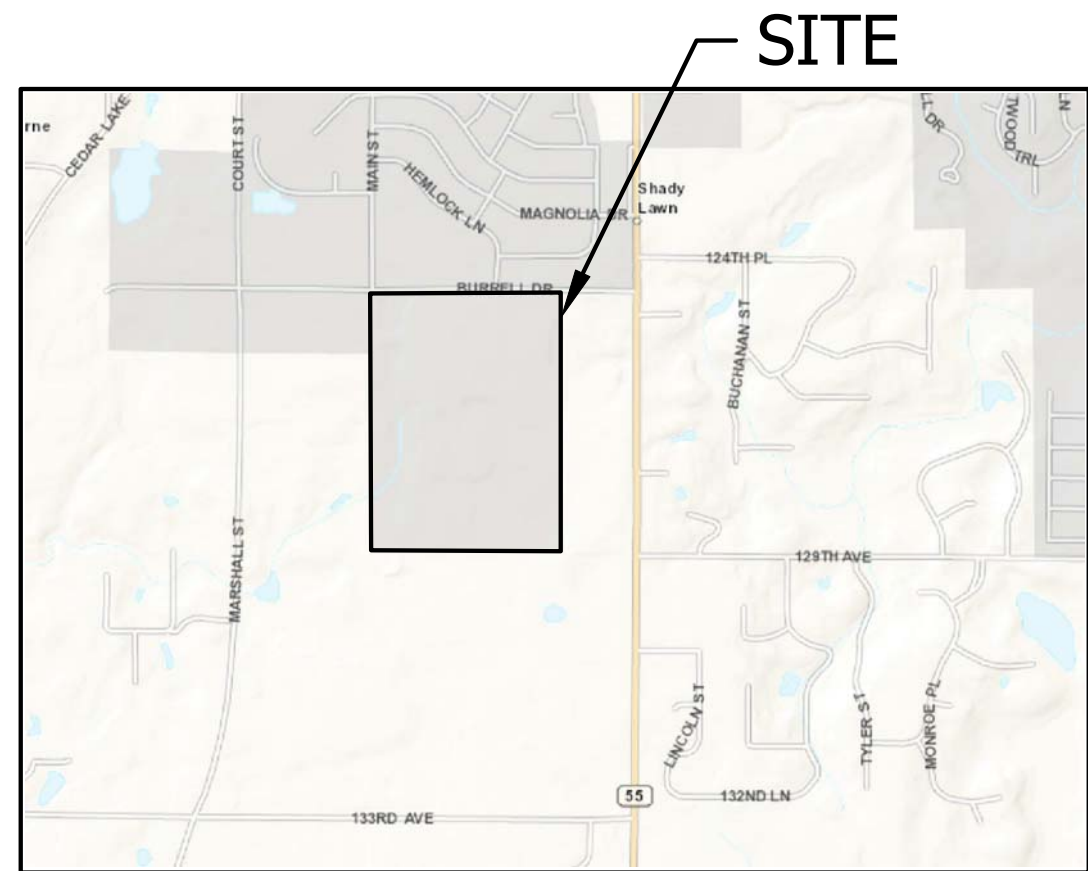

VICINITY MAP
NOT TO SCALE

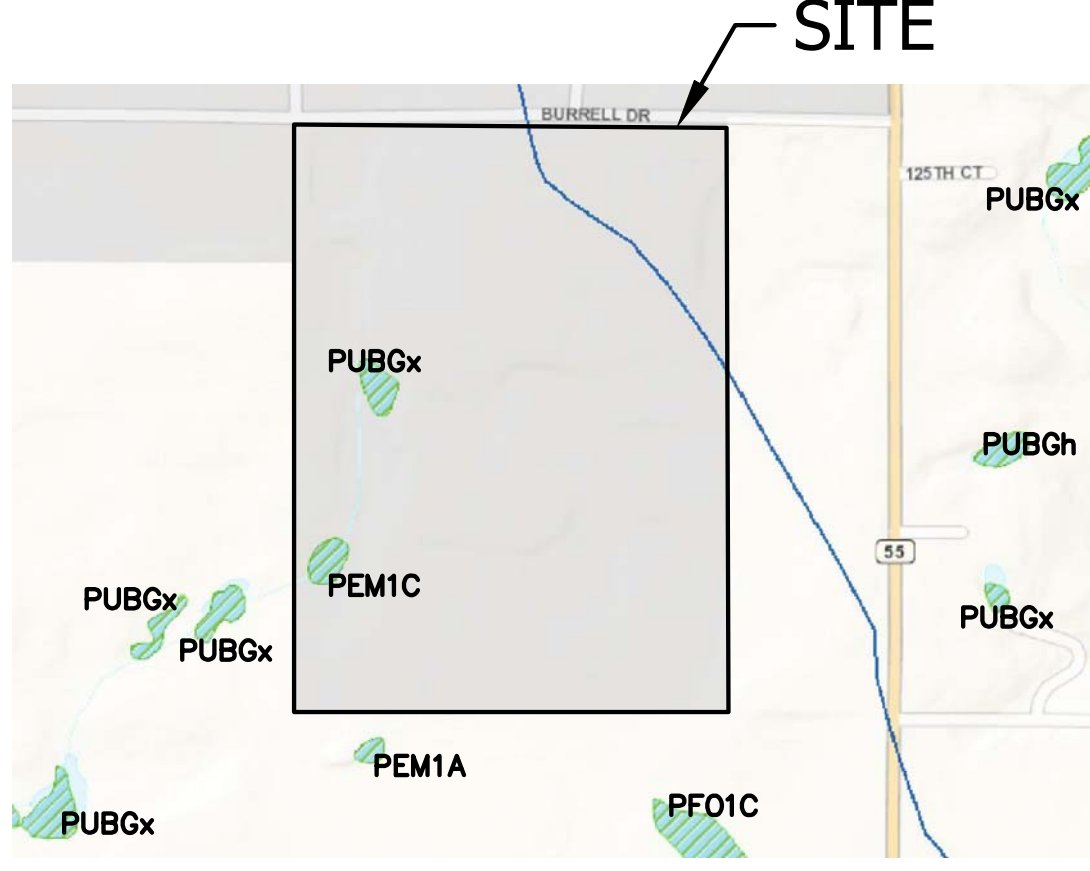

WETLANDS MAP
NOT TO SCALE

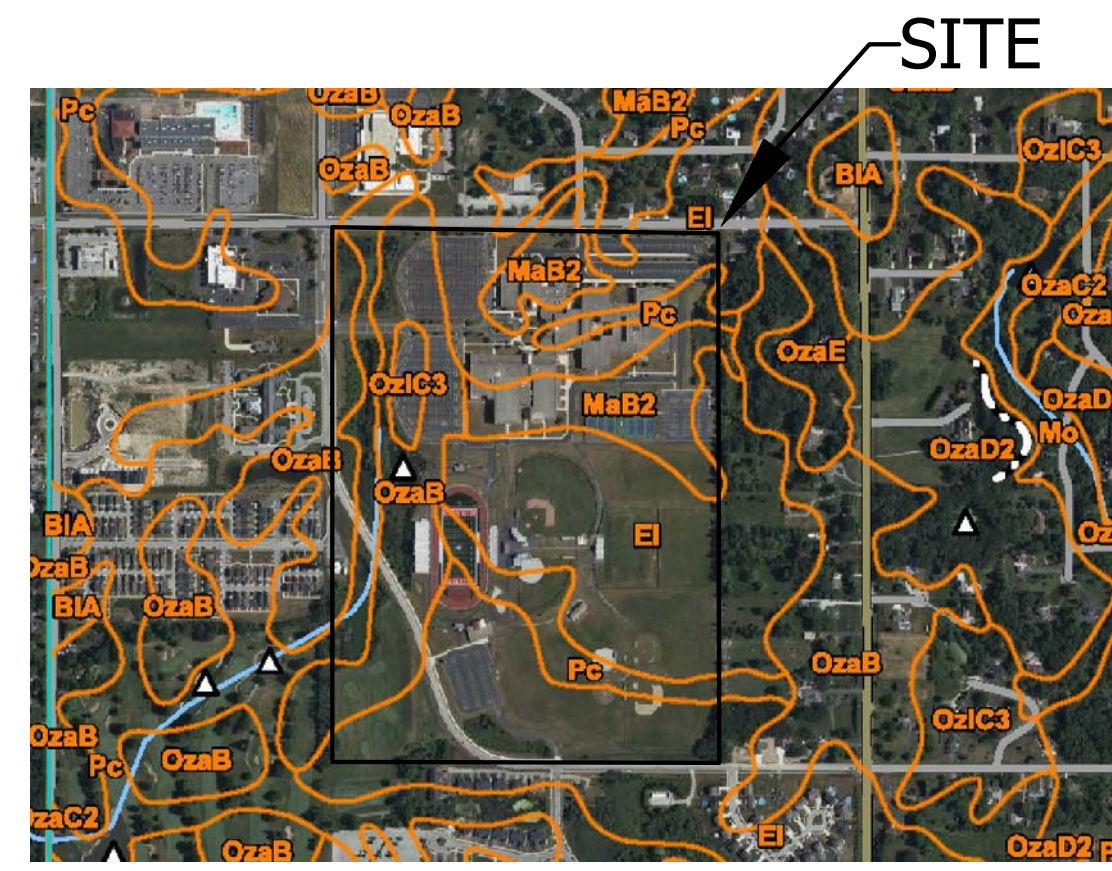

SOIL MAP
NOT TO SCALE

MAP UNIT SYMBOL	MAP UNIT NAME
EI	ELLIOT SILT LOAM, 0 TO 2 PERCENT SLOPES
MaB2	MARKHAM SILT LOAM, 2 TO 6 PERCENT SLOPES, ERODED
Pc	PEWAMO SILTY CLAY LOAM, CALCAREOUS VARIANT
OzaB	OZAUKEE SILT LOAM, 2 TO 6 PERCENT SLOPES
OzLC3	OZAUKEE SILTY CLAY LOAM, 2 TO 12 PERCENT SLOPES, SEVERELY ERODED

- SWPPP LEGEND:**
- TEMPORARY ENTRANCE/EXIT (GRAVEL OR MAT)
 - SOIL STOCK PILE
 - BASKET INSERT INLET PROTECTION
 - GRADE LIMITS (SEE NOTE 18)
 - SILT FENCE (SEDIMENT FENCE SEE NOTE 17)
 - CONCRETE WASH OUT AREA
 - POSTING RULE 5 NOI & NOS LETTERS AND LOCAL SWPPP PERMIT
 - TEMPORARY SEEDING (SEE NOTE 14)
 - CONTOUR (PROPOSED)
 - GRADES (PROPOSED)
 - ROCK CHUTE
 - GRASS LINED CHANNEL
 - STREET SWEEPING
 - EROSION CONTROL BLANKET

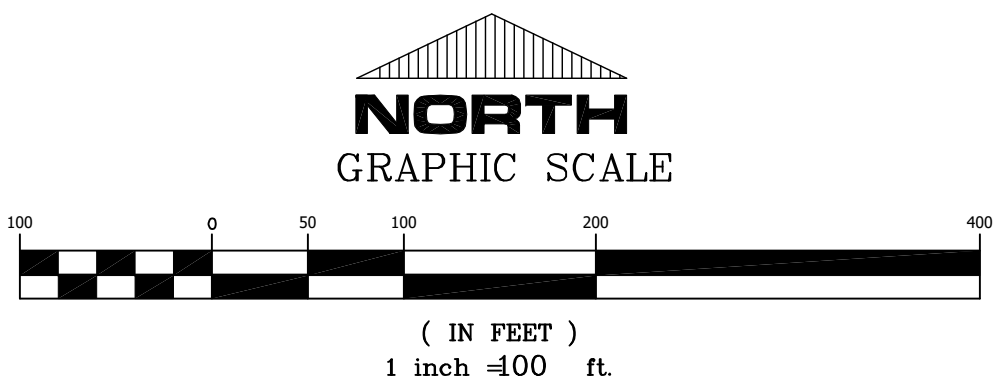

PROJECT CROWN POINT HIGH SCHOOL ADDITIONS AND RENOVATIONS

FOR:
CROWN POINT COMMUNITY
SCHOOL CORPORATION

CROWN POINT, INDIANA

GIBRALTAR DESIGN
9102 N. Meridian St., Ste. 300
Indianapolis, IN 46260
Homepage: www.GibraltarDesign.com
Email: info@GibraltarDesign.com
Phone: 317.580.5777 Fax: 317.580.5778

PROJECT
21-111
DATE
10/11/21
COORDINATED BY
DCT
DRAWN BY
DCT/EM
CHECKED BY
DCT

COPYRIGHT NOTICE:
THE CONCEPTS, DESIGNS, PLANS, DETAILS, ETC., SHOWN ON THIS DOCUMENT ARE THE PROPERTY OF GIBRALTAR DESIGN AND WERE CREATED FOR USE ON THIS SPECIFIC PROJECT. NONE OF THIS INFORMATION SHALL BE USED BY ANY PERSON OR FIRM FOR ANY PURPOSE WITHOUT THE EXPRESS WRITTEN CONSENT OF GIBRALTAR DESIGN. THE OWNER MAY RETAIN COPIES FOR INFORMATION AND REFERENCE IN CONNECTION ONLY WITH THIS PROJECT.

MARK	DATE	ISSUED FOR
AD-1	10-22-21	ADDENDUM NO. 1
AD-4	11-08-21	ADDENDUM NO. 4

DRAWING
MASTER STORM WATER
POLLUTION PREVENTION
PLAN - CONSTRUCTION

PROJECT
CROWN POINT HIGH SCHOOL
ADDITIONS AND RENOVATIONS

C-5.0

